

60-INCH ROUND COMMERCIAL STACKING TABLE (WHITE GRANITE)

80301 / SPECIFICATIONS



Grade	Commercial
Dimensions (Open)	60" Diameter x 29" H
Dimensions (Closed)	60" Diameter x 2.15" H
Table Top Material	High-Density Polyethylene (HDPE)
Table Top Thickness	54.6 mm
Frame Material	Powder-Coated Steel
Leg Tubing Diameter	19 mm x 34 mm
Weight	36.1 lbs. (16.3 kg)

- UV-Protected High-Density Polyethylene (HDPE) Top
- Tables Nest Together Saving Storage and Transportation Space
- Nesting Design Prevents Tables from Shifting when Stacked
- Superior Strength and Durability

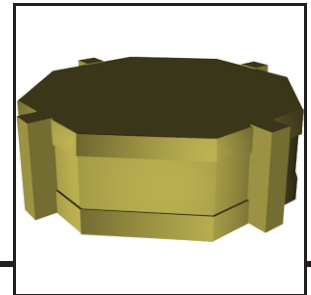

Pallet Dimensions

Quantity	15
Weight	850 lbs. (385,9 kg)
Length	61.5" (156,2 cm)
Width	61.5" (156,2 cm)
Height	34.1" (86,7 cm)
Cubic Feet	74.6 ft3 (2,1 m3)
Ship	LTL

Shipping Quantity

20' Container	90
40' Container	210
40' H Container	315
48' Truckload	405
53' Truckload	450



* Packaging may vary by model. Speak with your sales representative about individual model packaging.